

CONTROL ROD [G35M-R]

B3E051501025T12

Construction/Operation

- Movement of the shift lever when operated is transmitted as follows, resulting in gear shifting: cable→shift lever shaft→crank lever shaft→control rod.

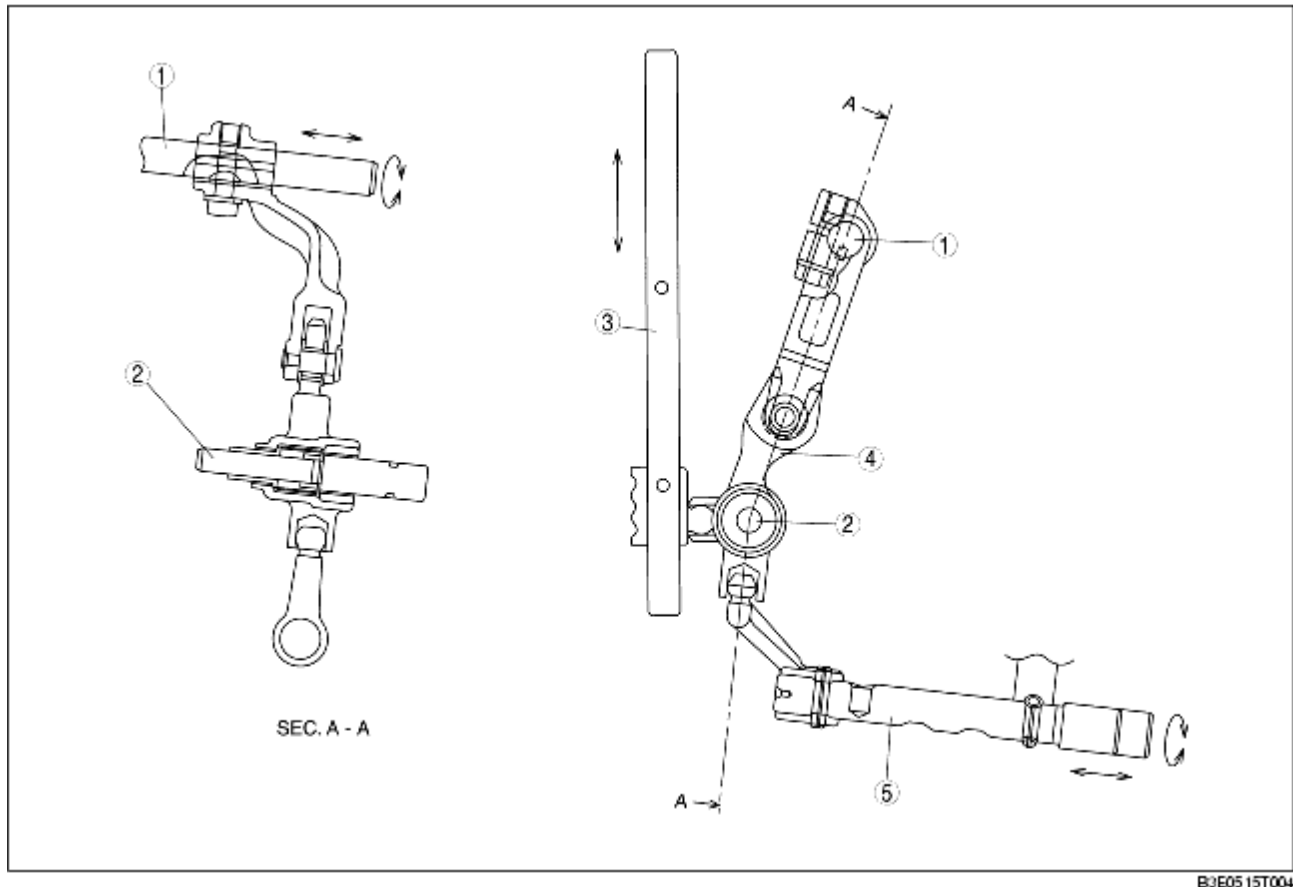

1	Shift lever shaft
2	Crank lever shaft
3	Control rod
4	Crank lever
5	Control rod